



DUAL PURPOSE Dielectric Anti-Fatigue Mats

Company

DUAL PUPOSE DIELECTRIC

- Quarter inch thick, ASTM-D-178, corrugated or diamond surfaced switch-board mats laminated to a 3/8" thick, super resilient polymeric sponge base provides employees a comfortable work surface to stand on while providing protection from accidental electrical shock.
- Rhino switchboard conforms to OSHA requirements for electrical protective devices with certification engraved on back.
- Rhino Dual-Purpose switch board matting also meets the optional requirements cited by ASTM for flame resistance, ozone resistance and oil resistance.

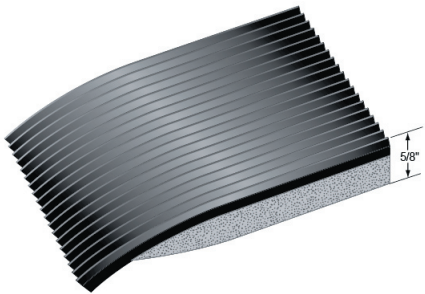

AVAILABLE IN CORRUGATED
OR DIAMOND SURFACE



DUAL PURPOSE DIELECTRIC ANTI-FATIGUE

Stock No.	Sizes	App. Wt.
DP-2436	2' X 3'	15.0 lbs.
DP-3648	3' X 4'	30.0 lbs.
DP-3660	3' X 5'	37.5 lbs.

DUAL PURPOSE CUT LENGTHS

Stock No.	Sizes	App. Wt./lin.ft.
DP-36	3' x 75'	7.5 lbs.
DP-48	4' x 75'	10.0 lbs.

Color: Black only. For Diamond surface, add the letter "D".
5/8" Thick.



FUSE BOX SAFETY Dielectric Mats

FUSEBOX SAFETY MAT

- Fusebox Safety mats provide a portable platform for personal protection of employees working near exposed energized breakers, fuses or circuit parts.
- 1/4" thick switchboard mat, ASTM D178 Class 2 specification, with a maxium use voltage of 17kv, laminated to a 3/8" thick sponge base.
- Fusebox Safety Mats are manufactured for personal protective equipment and comfort, they should only be used to offer "temporary" electrical insulation for energized equipment.
- Fusebox Safety Mats should not be relied upon solely to provide protection against (electrical) hazards, but should be used in conjunction with engineering safeguards and associated work practices. Overall size 16" x 18", 5/8" total thickness.



FUSEBOX SAFETY MAT

Stock No.	Sizes	Weight
FB1618	16" x 18" x 1"	2.5 lbs.

Color: Black



YOU STAND. WE DELIVER.



RHINO
ANTI-FATIGUE MATS

90
3
A
R
O
B
O
A
R
D
S
W
I
T
C
H
B
O
A
R
D
S



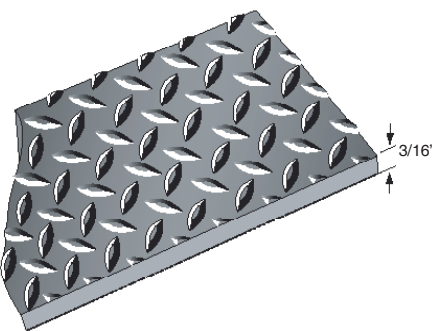
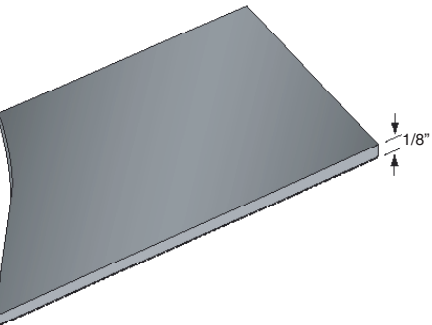
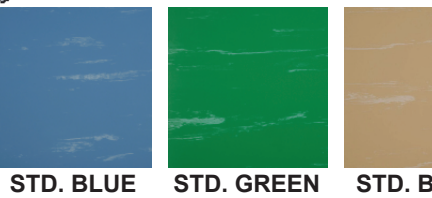
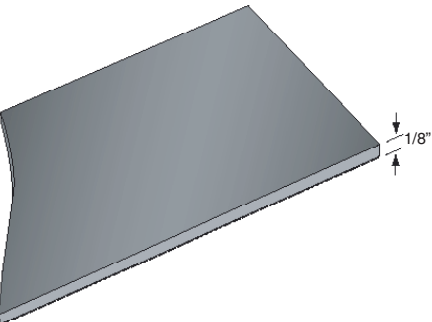
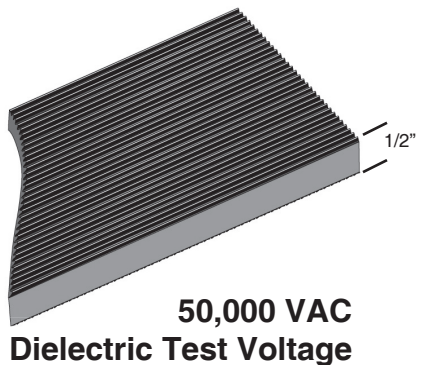
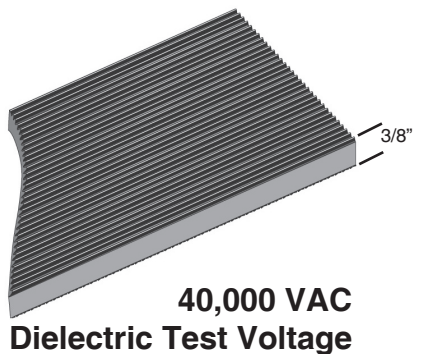
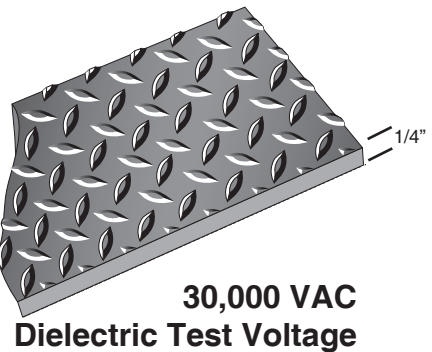
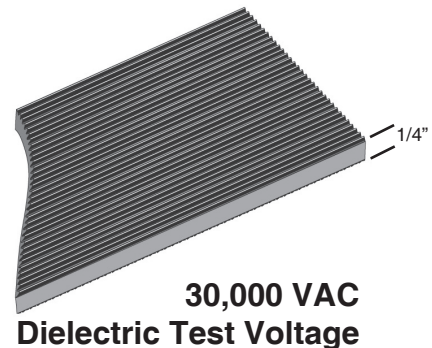
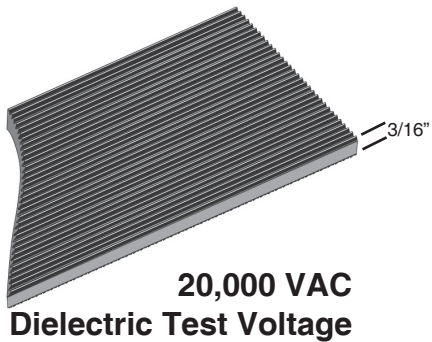

MIL-DTL-I5562 TYPE I (1/8") SMOOTH TOP

- Durable, marbled, fire-retardant, electrically insulating surface is installed in naval vessels in high-voltage compartments.
- The Type I matting offers aesthetics and water-tight integrity with heat welded seams.

- Dielectric Test Voltage 30,000 VAC
- Proof Tested Over Entire Surface At 15,000 VAC
- Recommended Maximum Use Voltage 3,000 VAC



MIL SPEC TYPE I SMOOTH TOP SWITCHBOARD MATTING		
Stock No.	Size	Weight/per roll
MILSPEC-I	36" x 75'	245.00 lbs
Standard Colors: Blue, Green, Beige, Gray.		
High Gloss: Blue, Green, Beige, Gray. Full rolls only. 1/8" Thick.		

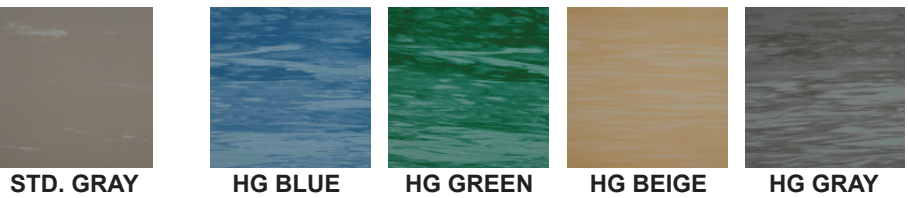

MIL-DTL-I5562 TYPE II (1/8") II SMOOTH TOP

- Type II smooth surface is fire-retardant, electrically insulating matting used as a portable runner in front of equipment and on workbenches.

- Dielectric Test Voltage 30,000 VAC
- Proof Tested Over Entire Surface At 15,000 VAC
- Recommended Maximum Use Voltage 3,000 VAC



MIL SPEC TYPE II SMOOTH TOP SWITCHBOARD MATTING		
Stock No.	Size	Weight/per roll
MILSPEC-II	36" x 75'	245.00 lbs
Color: Black-cut lengths and full rolls, Blue, Green-full rolls only. 1/8" Thick.		



MIL -DTL-I5562 TYPE III (3/16") DIAMOND

- The Type III. diamond plate surface is slip-resistant, fire-retardant, electrically insulating matting and is installed as a portable runner in front of equipment and on workbenches.
- Type III runner is used by the Department of Defense and in many industrial and commercial applications.

- Dielectric Test Voltage 30,000 VAC
- Proof Tested Over Entire Surface At 15,000 VAC
- Recommended Maximum Use Voltage 3,000 VAC



MIL SPEC TYPE III DIAMOND SWITCHBOARD MATTING		
Stock No.	Size	Weight/per roll
MILSPEC-III	36" x 75'	252.00 lbs.
Color: Gray-cut lengths and full rolls, Green-full rolls only. 3/16" Thick.		



CORRUGATED SWITCHBOARD MATTING

- A specially compounded non-conductive corrugated matting designed to help prevent electric shock around high voltage electrical equipment, such as fuse boxes, and control panels.
- Now meets all optional requirements for Ozone Resistance, Flame Resistance, and Oil Resistance.
- Tested to ASTM D178/ANSI J6.7. Certification engraved on back.

CLASS 1 - 3/16" Thick Switchboard - Corrugated		
• DIELECTRIC TEST VOLTAGE 20,000 VAC		
• PROOF TESTED OVER ENTIRE SURFACE AT 10,000 VAC		
• RECOMMENDED MAXIMUM USE VOLTAGE 7,500 VAC		
Stock #	Size	Weight/Ln.Ft.
SB336	3' x 75'	3.9 lbs.
Color: Black. Sold in cut lengths and full rolls.		
CLASS 2 - 1/4" Thick Switchboard - Corrugated & Diamond Pattern		
• DIELECTRIC TEST VOLTAGE 30,000 VAC		
• PROOF TESTED OVER ENTIRE SURFACE AT 20,000 VAC		
• RECOMMENDED MAXIMUM USE VOLTAGE 17,000 VAC		
Stock #	Size	Weight/Ln.Ft.
SB424	2' x 75'	3.5 lbs.
SB436	3' x 75'	5.2 lbs.
SB448	4' x 75'	6.8 lbs.
Color: Black. 3' Diamond also in black/yellow. Sold in cut lengths and full rolls		
CLASS 3 - 3/8" Thick Switchboard - Corrugated		
• DIELECTRIC TEST VOLTAGE 40,000 VAC		
• PROOF TESTED OVER ENTIRE SURFACE AT 30,000 VAC		
• RECOMMENDED MAXIMUM USE VOLTAGE 26,500 VAC		
Stock #	Size	Weight/Ln.Ft.
SB536	3' x 75'	7.7 lbs.
Color: Black. Sold in cut lengths and full rolls.		
CLASS 4 - 1/2" Thick Switchboard - Corrugated		
• DIELECTRIC TEST VOLTAGE 50,000 VAC		
• PROOF TESTED OVER ENTIRE SURFACE AT 40,000 VAC		
• RECOMMENDED MAXIMUM USE VOLTAGE 36,000 VAC		
Stock #	Size	Weight/Ln.Ft.
SB636	3' x 30'	10.7 lbs.
Color: Black. Sold in cut lengths and full rolls. Optional Bevel.		